

CHARMILL

RESIDENTIAL



Croxley Road, Maida Vale, W9

£577 Per week

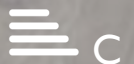

Croxley Road



Description

A two-bathroom first floor apartment set within a period conversion on Croxley Road. The property comprises a spacious reception room with wooden floor, separate fitted kitchen, two bedrooms and a bathroom suite. Croxley Road is a quiet tree lined residential location, located 0.4 miles from Queens Park (Overground and Underground Station) and in between Queens Park and Paddington Recreational Ground. There are numerous boutique shops, eateries, located on the sought-after Salisbury Road and Croxley Road is situated approximately one mile away from the famous Portobello Road.

- Two bedrooms
- One bathroom
- Separate kitchen
- First floor





Floor Plan

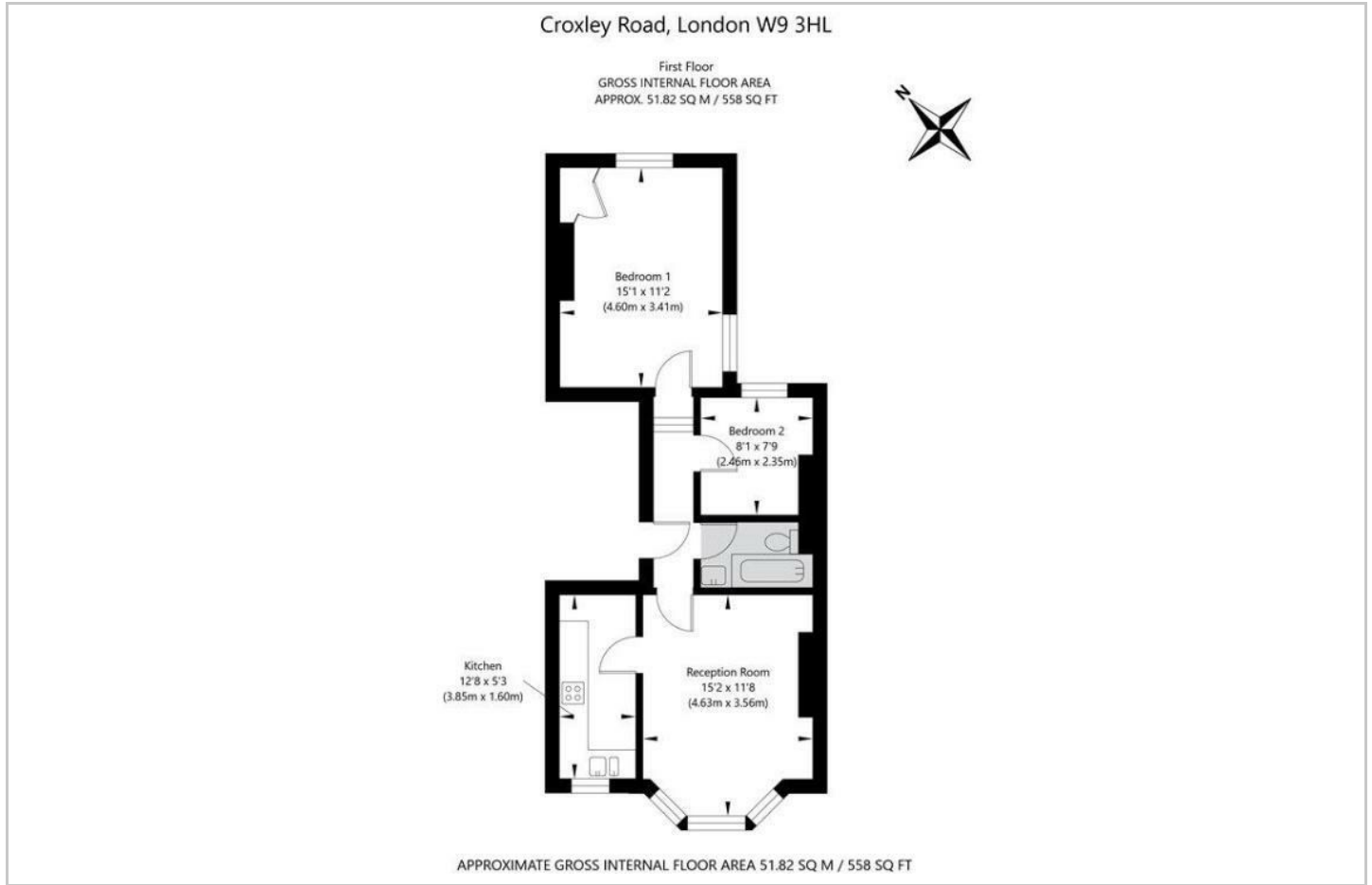

Area Map

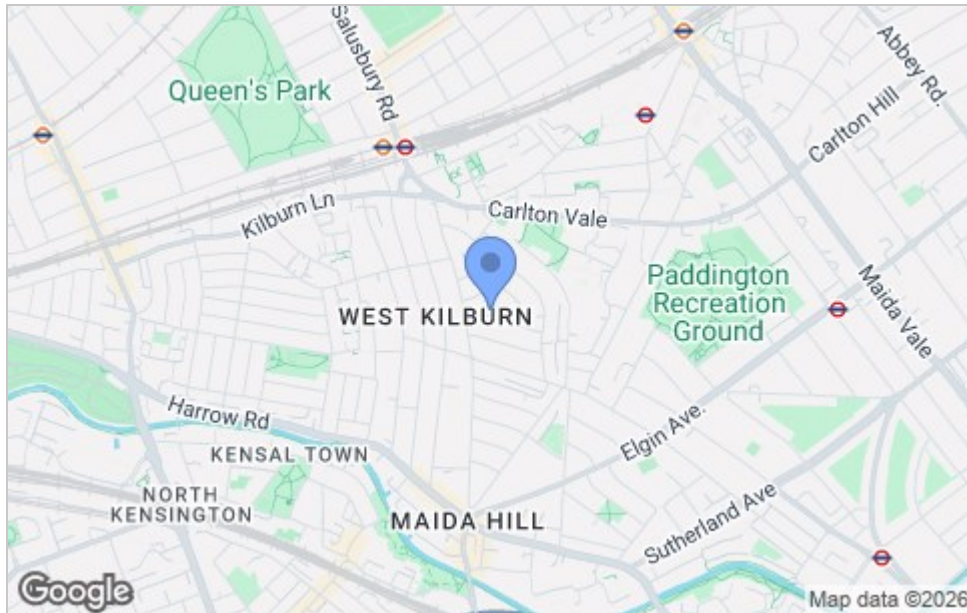

Energy Efficiency Graph

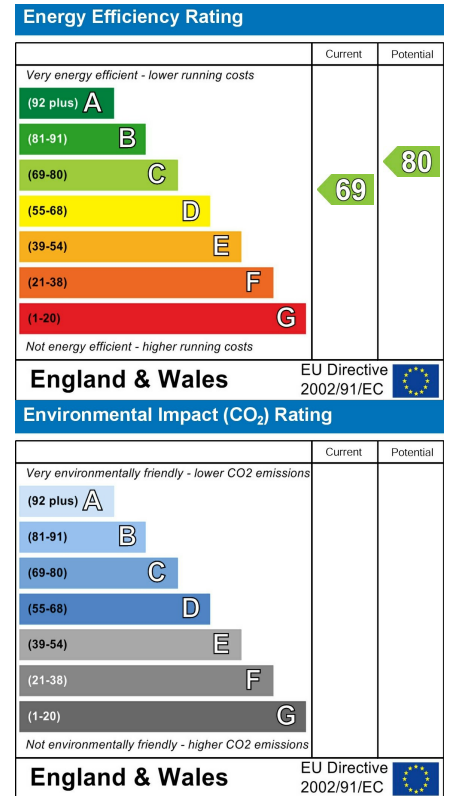

Viewing

Please contact us on 020 7046 6275 if you wish to arrange a viewing appointment for this property or require further information.



These particulars, whilst believed to be accurate are set out as a general outline only for guidance and do not constitute any part of an offer or contract. Intending purchasers should not rely on them as statements of representation of fact, but must satisfy themselves by inspection or otherwise as to their accuracy. No person in this firm's employment has the authority to make or give any representation or warranty in respect of the property.

020 7046 6275 • sales@chamillresidential.co.uk • 51 Maida Vale, Little Venice, London W9 1SD
 charmillresidential.co.uk